

Beneteau Oceanis 46.1
Sale and Purchase Agreement

36 Degrees Brokers Limited (*Seller*)

NZ Boat Share OC46.1-6 Limited (*Buyer*)

Stace Hammond
Lawyers
having offices at:

Level 7, KPMG Centre
85 Alexandra Street,
PO Box 19-101, DX GP 20026
Hamilton
New Zealand

Level 15
34 Shortland Street,
PO Box 106-376, DX CP 18012
Auckland
New Zealand

PARTIES

36 Degrees Brokers Limited, of 103/114 Westhaven Drive, Auckland Central, Auckland 1010 (the '**Seller**')

NZ Boat Share OC46.1-6 Limited, of C/- 36 Degrees Brokers Limited, 103/113 Westhaven Drive, Auckland Central, Auckland 1010 (the '**Buyer**')

BACKGROUND

- A The Seller has purchased the unnamed Beneteau Oceanis 46.1 directly from the builder, Beneteau, and wishes to sell the same to the Buyer.
- B The Buyer wishes to purchase the Vessel and pay the Purchase Price in the manner described in clause 1 but subject always to the termination rights in clause 5.
- C The Seller wishes to sell and transfer to the Buyer all its rights, title and interest in the Vessel.

NOW IT IS AGREED by the parties as follows:

1 DEFINITIONS

In this Agreement unless the context requires otherwise:

Agreement means this Agreement, the recitals and schedules attached hereto;

Beneteau Agreement means the agreement between Beneteau (as seller) and the Buyer (as purchaser) in relation to the sale and purchase of the Vessel;

Condition means the Condition set out in clause 3;

COVID-19 means Coronavirus disease 2019 (novel coronavirus) and includes any related or similar communicable diseases, strains, mutations or derivations thereof;

COVID-19 Event means any event, series of events or state of affairs beyond the reasonable control of the party affected by the event, series of events or state of affairs, arising directly or indirectly in relation to or in connection with COVID-19 (including, without limitation, any government-imposed measures such as border closures, quarantine restrictions, lockdowns, physical distancing requirements, government seizures, health advisory warnings or alerts), where as a consequence the affected party cannot reasonably be required or expected to perform its obligations under this Agreement;

Duties means official customs duties and/or taxes (including GST) that may become due and/or payable to New Zealand Customs or applicable Government agencies upon entry or exit of the Vessel into or from the port of delivery as contemplated under any applicable New Zealand Customs or tax related legislation or regulations;

Encumbrance includes any mortgage, charge (whether fixed or floating) pledge, lien, option, restriction as to transfer, use or possession and any other encumbrance, security or adverse interest whatsoever;

Equipment includes but is not restricted to the engine, gensets, steering gear, tender(s) (if any), communications equipment, electronics, life-saving, fire-fighting equipment and any spares whether aboard or ashore and as further outlined in Schedule 1;

GST means Goods and Services Tax as that term is defined in the Goods and Services Tax Act 1985;

Offer means the Buyer's public offer of shares in the Buyer to prospective investors;

Purchase Price means the sum of NZD\$1,112,000 including GST, unless any deductions are made in accordance with the terms of this Agreement;

Settlement means settlement of the sale and purchase of the Vessel under this Agreement;

Settlement Date means the date of Delivery described in clause 5;

Vessel means the Beneteau Oceanis 46.1, "Exit Point" her Equipment, fuel and all her documentation, as further outlined in Schedule 1.

2 **SALE AND PURCHASE**

- 2.1 The Seller shall sell and transfer and the Buyer shall purchase the Vessel on terms set out in this Agreement.

3 **CONDITION**

- 3.1 Settlement is conditional on settlement occurring under the Beneteau Agreement.

- 3.2 In order to fulfil the Condition, each of the Seller and the Buyer will:

- (a) use all reasonable endeavours, and co-operate with the other;
- (b) do all acts, matters and things within its power and control; and
- (c) provide such information as may be required,

to cause the Condition to be satisfied, provided that this clause 3.2 will not require a party to pay any money (other than normal fees, costs and charges of professional advisers) or incur any material liability in order to satisfy the Condition.

- 3.3 The Condition has been inserted for the benefit of both the Seller and the Buyer and may only be waived by agreement between them. If waived, the Condition will be deemed to be fulfilled.

- 3.4 The Seller and the Buyer will each notify the other promptly upon becoming aware that the Condition has been satisfied.

- 3.5 If the Condition is not satisfied (or waived in accordance with clause 3.3 by 5:00 p.m. on the date which is 30 days after the date of this Agreement or a later date agreed in writing by the parties, either the Seller or the Buyer may (if the party wishing to terminate has complied with its obligations under clause 3.2) terminate this Agreement at any time by notice in writing to the other party and no party will have any claim against any other party arising under or in connection with that termination.

4 **PURCHASE PRICE**

- 4.1 Payment of the Purchase Price shall be made by way of bank transfer to the Seller's nominated bank account in accordance with clause 4.2.

- 4.2 The Buyer shall pay the Purchase Price to the Seller as the Buyer receives the relevant subscription proceeds from each share issued in accordance with the terms of the Offer (however, no such amount is required to be paid before the Settlement Date). The parties acknowledge and agree that in the event the Purchase Price (and associated issue costs in the order of \$22,000) has not been paid in full on the closing date under the Offer then (at the Seller's option):

- (a) the Seller will have the right (but not the obligation) to subscribe for any unsold share(s) under the Offer and may offset any amounts outstanding to it under this Agreement against any issue price payable under the Offer; or
 - (b) any amounts outstanding by the Buyer to the Seller under this Agreement shall become a loan and such loan shall only be repayable by the Buyer in the event that the Buyer receives payment for the remaining shares that otherwise were to be issued under the Offer.
- 4.3 The Purchase Price does not include any capitalised interest and is the lowest price that the parties would have agreed upon for the Vessel under the rules relating to the accruals treatment of income and expenditure in the Income Tax Act 2007 and on that basis no income and expenditure arises under those rules.
- 4.4 The parties acknowledge that GST, taxes and/or Duties (if any) may or may not become payable on the Purchase Price. If required the Seller shall provide the Buyer with a tax invoice for the Purchase Price prior to the Settlement Date. The Buyer shall pay GST and/or taxes (if any) on payment of the Purchase Price if required by law.
- 4.5 The Buyer shall be liable for any Duties (if any) that may become due after Settlement and agree to indemnify and hold harmless the Seller in respect of the payment or obligation to pay such Duties, provided at all times that such liability has not arisen as a result of the Seller's failure to attend to any Duties (if any) arising prior to Settlement. The Seller shall remain liable for any taxes and/or Duties (if any) due or becoming due prior to Settlement and indemnifies and holds harmless the Buyer in respect of the payment or obligation to pay such Duties.

5 DELIVERY, SETTLEMENT AND TITLE

- 4.1 The Seller shall deliver and give title and possession to the Buyer of the Vessel on the Settlement Date and concurrently hand to the Buyer the documents outlined in clause 8 ('Delivery') as soon as reasonably practicable following the Vessel being ready and available for such Delivery.
- 4.2 The Settlement Date shall be the date of Delivery, which is expected to be on or around 1 December 2023, but is subject to change. The Seller shall keep the Buyer informed of the anticipated date of Delivery.
- 4.3 All risk in the Vessel shall pass to the Buyer at the time of Delivery, and the Buyer assumes all costs, and expenses relating to the Vessel subject always to clause 9.
- 4.4 Should the Vessel become an actual, or constructive total loss before Delivery this Agreement shall be deemed null and void and neither party shall have any claim as against the other.

5 OFFER CANCELLED

- 5.1 In the event that the Offer is withdrawn or cancelled for any reason whatsoever, the Buyer or the Seller may cancel this Agreement by written notice to the other party and this Agreement shall be deemed null and void and of no legal effect.
- 5.2 In the event of termination of this Agreement pursuant to clause 5.1, the Seller shall return any moneys paid to it by the Buyer (if any) and neither party shall have any further claim as against the other.

6 COVID-19

- 6.1 The Seller or the Buyer may terminate this Agreement at any time before Settlement by notice in writing to the other if a COVID-19 Event occurs before Settlement.
- 6.2 If the Seller or the Buyer terminates this Agreement under clause 6.1, no party shall have any claim against the other arising under or in connection with this Agreement.

7 INSPECTION

- 7.1 The Seller purchased the Vessel in a used condition. The vessel was launched in June 2023 and has been maintained to a high standard to insure it is in the condition expected of a vessel of its age and usage. The vessel is in excellent used condition and has been commissioned and tested fully, being seaworthy and light wear and tear.
- 7.2 The Buyer has inspected the Vessel and her documentation and accepts the Vessel as being in the condition expected of a second hand vessel in near new condition and this sale is unconditional and outright and subject only this Agreement. The Vessel is sold on an 'as is, where is' basis, subject only to the warranties contained in this Agreement. The Buyer acknowledges that it has entered into this Agreement relying solely upon its own judgment and not upon any representation by the Seller or its representatives except as contained in this Agreement.

8 DELIVERY DOCUMENTS

- 8.1 On the Settlement Date, the Seller shall provide the Buyer the following delivery documents:
- (d) Legal Bill of Sale transferring title to the Vessel and stating that the Vessel is free from all mortgages, maritime liens, encumbrances and debts whatsoever;
 - (e) Tax invoice for the Vessel (if required);
 - (f) Any additional documents as may be reasonably required by the competent authorities of the Buyer's nominated Flag State for the purpose of registering the Vessel (if required), provided the Buyer notifies the Seller of any such documents as soon as possible after the date of this Agreement;
 - (g) All records, diagrams, manuals, drawings, schematics, log books and other documentation on the Vessel, or in the Seller's possession pertaining to the Vessel, its machinery and equipment at Settlement Date; and
 - (h) Valid transfer or assignment of any builder's and/or OE manufacturer warranties relating to the Vessel and/or her Equipment where capable of assignment.

9 SELLER WARRANTIES AND INDEMNITY

- 9.1 The Seller represents and warrants to the Buyer as at the Settlement Date, that:
- (a) The Vessel is legally and beneficially owned by the Seller and the Seller has full power and authority to sell and transfer to the Buyer the Vessel.
 - (b) There are no agreements or restrictions whether arising out of any legislation, regulations, agreement or otherwise preventing, restricting or inhibiting the Seller from carrying out the sale and transfer of the Vessel.
 - (c) Upon receipt of the Purchase Price, title in the Vessel and all equipment will pass to the Buyer free from any liabilities, claims, mortgages, liens, charges, liabilities (actual, threatened or contingent) or other encumbrances whatsoever.

- 9.2 The Seller further covenants and agrees with the Buyer to indemnify and save harmless the Buyer from and against any and all claims, demands, actions, suits, proceedings, costs, liabilities and expenses (collectively called '**the Claims**') which may be brought or made against the Buyer (or the Vessel) or which the Buyer may suffer or incur as a result of or arising out of or in respect to any misrepresentation, breach of warranty on the Seller's part under this Agreement provided always that any Claims relate to matters arising prior to delivery of the Vessel to the Buyer. The Buyer will notify the Seller of any claims and the Seller will be afforded a reasonable opportunity at the Seller's expense to resist, defend or compromise any such Claims.

10 BUYER WARRANTIES

- 10.1 The Buyer represents and warrants to the Seller as at the date hereof and as at the Settlement Date, that the Buyer is authorised to enter into this Agreement and that there is no impediment or restriction legal or otherwise preventing the Buyer's compliance with its obligations under this Agreement.

11 INSURANCE

- 11.1 It is acknowledged and agreed by the Buyer that all insurance/s in respect of the Vessel shall be the sole responsibility of the Buyer at and from the Settlement Date including but not restricted to the cost, expense and procuring of such insurance/s in the name of the Buyer.

12 ARBITRATION

- 12.1 The parties acknowledge that they will use their best endeavours to effect an amicable and expeditious resolution of any disputes arising in respect of this Agreement or any agreements concurrently entered into, but in the event that a decision cannot be effected, any dispute arising out of or in connection with this Agreement, including any question regarding its existence, validity, or termination, shall be referred to arbitration in Auckland by a sole arbitrator in accordance with the Arbitration Rules of the Maritime Law Association of Australia and New Zealand ('MLAANZ').

13 MISCELLANEOUS

- 13.1 Each party covenants that it will from time to time sign, execute, process and pass and do all such further documents, acts, matters and things as shall be reasonably necessary or requisite for effecting the provisions of this Agreement.
- 13.2 Failure or omission by a party at any time to enforce or require strict or timely compliance with any provisions of this Agreement shall not affect or impair that provision in any way, or the rights of that party to avail itself of the remedies it may have in respect of any breach of any such provision.
- 13.3 Each party shall bear its own costs relating to the preparation of this Agreement and the transfer of the Vessel.
- 13.4 This Agreement may be executed in two or more counterparts, each of which shall be deemed to be an original and all of which taken together shall constitute one and the same instrument. Facsimile or email copies of the Agreement received by a party shall be interpreted as being conclusive evidence of the execution of the same in terms of this clause. Each party shall sign an original of the same as soon as possible if the provisions of this clause are utilised and shall supply such original to the other party forthwith.
- 13.5 This Agreement together with any Schedules form the entire agreement between the Parties unless otherwise specifically agreed in writing between them and supersedes all previous communications (whether oral or in writing), representations, agreements or understandings.

13.6 This Agreement will be governed by and interpreted in accordance with the laws of New Zealand and the parties submit to the non-exclusive jurisdiction of the New Zealand Courts.

EXECUTION

Signed on behalf of 36 Degrees Brokers Limited by its authorised director(s)/attorney(s):

(Note: If the company has more than one director, two directors must sign. If the company has one director, that director's signature must be witnessed below.)

Signature of witness

Charlie Bott

Full name of witness

Project Manager

Occupation

Auckland

City/town of residence

Director/Attorney (signature)

Full name

CONRAD WILLIAM GAIR.

Signed on behalf of NZ Boat Share OC46.1-6 Limited by its authorised director(s)/attorney(s):

(Note: If the company has more than one director, two directors must sign. If the company has one director, that director's signature must be witnessed below.)

Signature of witness

Charlie Bott

Full name of witness

Project Manager

Occupation

Auckland

City/town of residence

Director/Attorney (signature)

Full name

CONRAD WILLIAM GAIR.

Schedule 1
Vessel Specifications and Inventory

Beneteau Oceanis 46.1 "Exit Point"

- 3 cabin 2 head version
- Walnut alpi interior
- Downwind sailing pack including Code Zero
- Mainsail arch
- Electric winches
- BBQ built into cockpit seat
- Diesel Heating
- Microwave oven
- Fusion Bluetooth sound system
- Interior loud speakers and waterproof outdoor speakers
- Stainless steel cooker 2 burner oven/grill on gimbal
- 3 folding blade propeller
- 80HP YANMAR engine
- TV with Streaming via Onboard WIFI
- Electronically opening bathing platform with remote
- Windlass anchor control in cockpit with chain counter
- 85 ice box top opening
- 130 litre front opening refrigerator
- Cockpit table with glass holders and lighting
- Self-tacking / furling jib
- Upgraded Bimini / dodger with side covers & solar
- Macadamia padding upholstery – saloon & cabins
- Mosquito nets on port holes
- Autopilot
- State of the art navigation systems and screens
- Bow thruster
- Sunbed mattresses for companionway
- NZ Electrical certification
- Extra 200L water tank
- Double berth in saloon
- Electric quiet flush toilets
- Takacat tender with Electric outboard
- High quality linens and towels for all cabins
- Kitchen amenities including
 - Cutlery
 - Tea towels, dishcloths etc
 - Pots/Pans
 - Serving ware
 - Plates, bowls and other crockery
 - Kitchen provisions such as salt, pepper, cooking oil



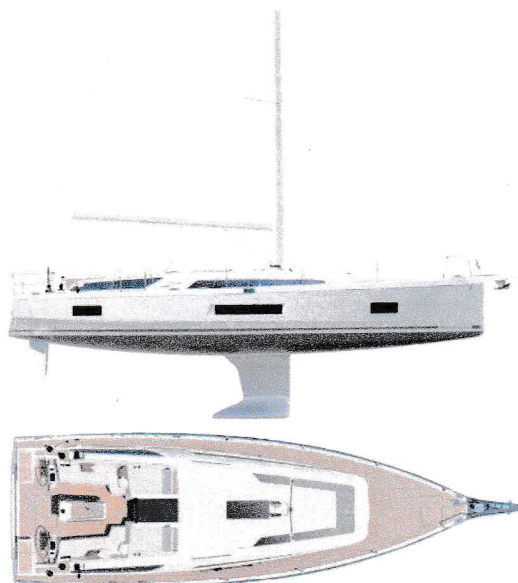

3 cabins 2 heads version:

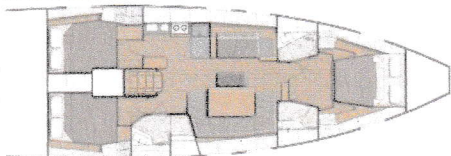

3 cabins 3 heads version:

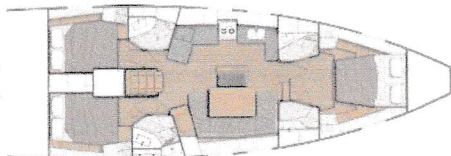

4 cabins 2 heads version:

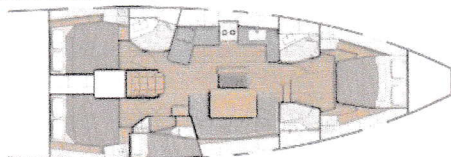

4 cabins 4 heads version:

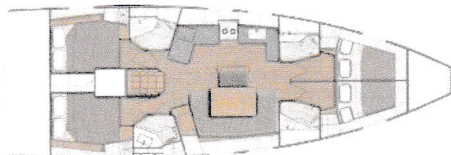

5 cabins 3 heads version:

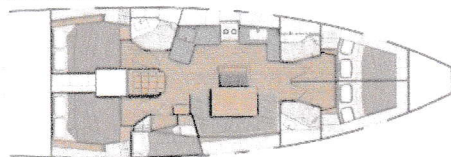

September 24, 2021 - (non-binding document)

GENERAL SPECIFICATIONS

• L.O.A	14,60m	47'11"
• Hull length	13,65m	44'9"
• L.W.L.	13,24m	43'5"
• Beam	4,50m	14'9"
• Deep draft (Cast iron)	2,35m	7'9"
• Deep ballast weight	2 735kg	6,028 lbs
• Shallow draft (Cast iron)	1,75m	5'9"
• Shallow ballast weight	3 061kg	6,746 lbs
• Performance draft (Cast iron/Lead)	2,65m	8'8"
• Ballast weight performance	2 576kg	5,678 lbs
• Air draft	20,31m	66'8"
• Air draft (Mast Performance)	21,31m	69'11"
• Light displacement	10 597kg	23,356 lbs
• Fuel capacity (standard)	200L	53 US Gal
• Fuel capacity (Option)	200L	53 US Gal
• Fresh water capacity (standard)	370L	98 US Gal
• Fresh water capacity (Option)	200L	53 US Gal
• Engine power (standard)	57 HP	57 HP
• Engine power (Option)	80 HP	80 HP

ARCHITECTS / DESIGNERS

- Naval Architect: Pascal Conq
- Outside & interior design: Nauta Design

EC CERTIFICATION

- Category A - 10 people
- Category B - 11 people
- Category C - 12 people

STANDARD SAILS DIMENSIONS

• Furling mainsail (standard)	44,50m ²	479 sq/ft
• Self-tacking jib (standard)	40,42m ²	435 sq/ft
• Classic mainsail	54m ²	581 sq/ft
• Furling genoa (109 %)	52,16m ²	561 sq/ft
• Code 0	102m ²	1,098 sq/ft
• Asymmetric spinnaker	152m ²	1,636 sq/ft
• I	17,72m	58'2"
• J	5,72m	18'9"
• P - Roller furling mast	16,57m	54'4"
• P - Classical mast	16,82m	55'2"
• E	5,630m	18'6"

PERFORMANCE (Extended classic mast)

• Classic mainsail	57,60m ²	620 sq/ft
• Genoa	57,80m ²	622 sq/ft
• I	18,33m	60'2"
• J	5,71m	18'9"
• P	17,82m	58'6"
• E	5,63m	18'6"

Code Bénéteau V12701 (C) Eng



BENETEAU

Oceanis 46.1

General Equipment list - Europe

STANDARD EQUIPMENT

CONSTRUCTION

- Design in accordance with European Directive requirements and according to CE certification
- Monolithic polyester contact hull
- Monolithic contact structural counter mould (Fabrics - resin) bonded to the hull
- Injected deck construction in glass fiber and Saerform foam sandwich, covered with non-slip diamond pattern
- Cast iron keel fixed with bolts and stainless steel backing plates
- Twin rudders hung with stainless steel stock
- White coloured hull - Grey metal hull graphics
- 8 Hull portholes

DECK EQUIPMENT

RIGGING

- Anodised aluminum mast, deck stepped with in-mast furling system, 2 Aft swept spreaders
- Anodised aluminum boom
- Cathedral type single-strand stainless steel standing rigging
- Split backstay
- Rigid boom vang with tackle
- Self-tacking jib with on-deck furler
- 2 Stand Up mainsheet blocks on the coachroof
- 1 Self-tacking jib track with traveller
- All lines brought back to the helm stations (except boom topping lift and genoa halyard)
- Complete running rigging: Mainsail halyard, Genoa halyard with cleat on mast, Boom topping lift with cleat on mast, Mainsheet, 1 Self-tacking jib sheet
- 6 Clutches
- Halyard covers
- 2 Flag halyards

WINCHES

- 1 Self tailing winch (H40.2 STA) at each helm station
- 1 Aluminum Speed Grip winch handle
- 2 Winch handle holders

SAILS

- Furling mainsail Dacron, with UV protection Natural, horizontal cut,
- Self-tacking jib Dacron with UV protection Natural, horizontal cut

MOORING LINES - MOORING

- Self-draining chain locker - Clench bolt - Hatch cover
- Single roller stainless steel bow fitting with offset roller
- 12 V - 1 000 W vertical electrical windlass - Remote control
- 6 Aluminum mooring cleats, Length: 400mm / 15³/₄" - Stainless steel chafing plate

SAIL LOCKER

- Access by polyester cover, Passage width: 65 x 50 cm / 2'2" x 1'8"
- Stainless steel ladder
- Shelving unit

SAFETY ON DECK

- 1 Open stainless steel pulpit
- 2 Stainless steel pushpits
- 2 Stainless steel handrails on coachroof
- 1 Lifebuoy support bracket
- Welded ring on pushpit for flag
- Double guard lines and stainless steel stanchions, 650mm / 2'2"
- Emergency ladder on pushpit

COCKPIT

- Self-draining cockpit
- 1 Watertight compartment under cockpit benches & 1 Wet locker
- 1 Locker in cockpit bottom
- 1 Gas compartment under port helmsman seat
- Teak slats on cockpit benches
- Solid wood slatted helm seats with starboard storage locker
- Foldaway helmsman foot chock
- 2 Steering wheel consoles: Stainless steel steering wheels (900mm diameter / 2'11") - Anthracite leather covering - Steering gear at the helm station - Steering line transmission system - Stainless steel handrail
- 2 Deck access for emergency tiller
- 1 Emergency tiller
- 1 Steering compass on the cockpit table
- Engine throttle and control panel on starboard
- Cockpit table, stainless steel frame, 2 wooden leaves, lighting, 4 glass holders, stainless steel handrails, lift raft storage
- 1 Cockpit shower with mixer tap
- 1 PMMA companionway door in 2 removable parts - Sliding hatch made of PMMA

SWIM PLATFORM / AFT TRANSOM

- Fully opening transom, convertible to bathing platform (2,65m x 0,80m / 8'8" x 2'7")
- Intermediate cockpit access step
- Manual control opening
- Teak decking on swim deck
- 1 Stainless steel, removable bathing ladder with dedicated stowage in the cockpit

INTERIOR

- Alpi walnut woodwork
- Rovere Aleve type laminated floorboards
- Interior cushions in cloth
- Padded lining in saloon (Beige)
- Mattresses in the cabins, HR35kg/m3 foam

Standard version: 3 cabins 2 heads version

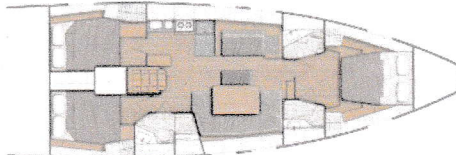

COMPANIONWAY

- Headroom: 1,98m / 6'6"
- Wooden saloon companionway with moulded wood suspended steps with non-slip surface
 - 1 Stainless steel handrail with anthracite leather sheathing (to port)

SALOON - STARBOARD

- Headroom: 2,01m / 6'7"
- U shaped saloon bench
 - Saloon table - wooden top
 - Central seat facing the table, without backrest
 - Mirror on bulkhead, at base of companionway
 - Storage under bench seats
 - Stowage provided under the floor (Stowage for bottles + 2 2 plastic baskets)
 - Piston-assisted hinges opening mechanism
 - Bookshelf against forward bulkhead
 - 1 Electrical panel for access to electrical connections (To starboard)
 - 2 Hull portholes
 - 2 Coaming glazing
 - 2 Opening deck hatches with mosquito screen/blinds

CHART TABLE & SOFA - PORT

- Headroom: 1,94m / 6'4"
- Table with storage- moulded wood fiddle - Laminated covering
 - Meridian function seat facing the saloon
 - 1 Flexible and swivelling reading light
 - 2 USB sockets
 - 1 Hull porthole

GALLEY - PORT

- Headroom: 1,94m / 6'4"
- L-shaped galley
 - Work top in Clay compact with Corian fiddles
 - Stainless steel sink 2 rectangular basins - 1 Mixer tap with hot/cold water under pressure - Clay compact sink cover with cutting board function on back
 - 1 Gas cooker 2 burners - Stainless steel oven on gimbal - Stainless steel protection handrail
 - 1 85 litre ice box, top opening (without refrigeration unit)
 - 1 130 litre refrigerator (12V), front opening
 - Fitted lockers and closed shelving
 - Bin under sink
 - Low unit: 1 Drawer, 2 Doors against companionway bulkhead
 - 1 Opening portlight with curtains in the coachroof side window
 - 1 Hull porthole

OWNER'S CABIN

- Headroom: 1,95m / 6'5"
- Central double bed (2,00m x 1,53m x 1,23m / 6'7" x 5' x 4')
 - 2 Hanger closets, Open storage compartment along the hull, 6 Upper lockers, 1 Drawer under the bed
 - 1 Storage locker either side of the bed
 - 2 Night tables
 - 2 Flexible and adjustable bedside lamps
 - 2 USB sockets
 - 2 Flush deck hatches with mosquito screen/blind
 - 2 Hull portholes with sliding blind

2 PRIVATE HEADS:

Headroom: 1,93m / 6'4"

to port:

- Manual toilet
- 1 50 L / 13 US Gal rigid holding tank
- 1 Polyester basin - Mixer tap
- 1 Cabinet - Mirror
- Toilet accessories
- 1 Deck hatch with mosquito screen/blind

To starboard:

- Shower with wooden seat, white polyester shower base
- 2 storage closets
- 1 Deck hatch with mosquito screen/blind
- Basin with mixer tap

PORT AFT CABIN

- Headroom: 1,92m / 6'4"
- 1 Double bed (2,05m x 1,40m / 6'9" x 4'7")
 - 1 Hanging locker - 2 Cupboards - 1 Cubby hole locker
 - 1 Bed access sideboard
 - 2 flexible and multi-directional reading lights at bedhead
 - 2 USB sockets
 - 1 Hull porthole with sliding blind
 - 1 Cockpit opening window with curtain under cockpit seats
 - 1 Fixed cockpit window with curtain on the coaming

STARBOARD AFT CABIN

- Headroom: 1,92m / 6'4"
- 1 Double bed (2,05m x 1,40m / 6'9" x 4'7")
 - 2 Cupboards - 1 Cubby hole locker
 - 1 Bed access sideboard
 - 2 flexible and multi-directional reading lights at bedhead
 - 2 USB sockets
 - 1 Hull porthole with sliding blind
 - 1 Cockpit opening window with curtain under cockpit seats
 - 1 Fixed cockpit window with curtain on the coaming

AFT HEAD - STARBOARD

- Headroom: 1,92m / 6'4"
- Access from the saloon or the starboard aft cabin
 - Separate shower - Self-draining storage bin - 1 Mixer tap - White polyester shower base
 - 1 Manual toilet
 - 1 64 L / 17 US Gal rigid holding tank
 - 1 Polyester basin - 1 Hot/cold water mixer tap
 - 1 Cabinet + Storage space under the basin
 - 2 Mirrors
 - Toilet accessories
 - 2 Opening ports on coaming with curtains on side windows